

2.11 BOMB OR CHEMICAL SPILL PROCEDURE

INTRODUCTION

In the event of a bomb scare or chemical spill, staff must know how to protect themselves and the children from risks of harm and follow a safety procedure.

PURPOSE

Lindfield Montessori School aims to protect the wellbeing and safety of staff, children, and other persons at the school.

STRATEGIES

Lindfield Montessori School endorses the following procedure, to be followed in the event of a bomb or chemical spill:

- Staff are to stay calm and comfort any child experiencing distress
- Activate RACE (Rescue + Alarm + Contain + Evacuate)
- The Nominated Supervisor is to telephone emergency services on 000
- The Nominated Supervisor is to assess the emergency
- The staff are to set up a safety cordon around the affected area – e.g. close doors, prevent children’s access to the spill
- If safe to do so, staff are to turn off all electrical equipment
- Staff must attempt to ensure no one uses a mobile telephone or starts a motor vehicle in close proximity to the hazard
- The evacuation procedure is to be followed
- An incident report is to be completed

POLICY REVIEWED	MODIFICATIONS	NEXT REVIEW DATE
September 2021	Updated copy	September 2023
April 2023	Updated Evacuation Plan	April 2024

EMERGENCY EVCUATION PROCEDURE

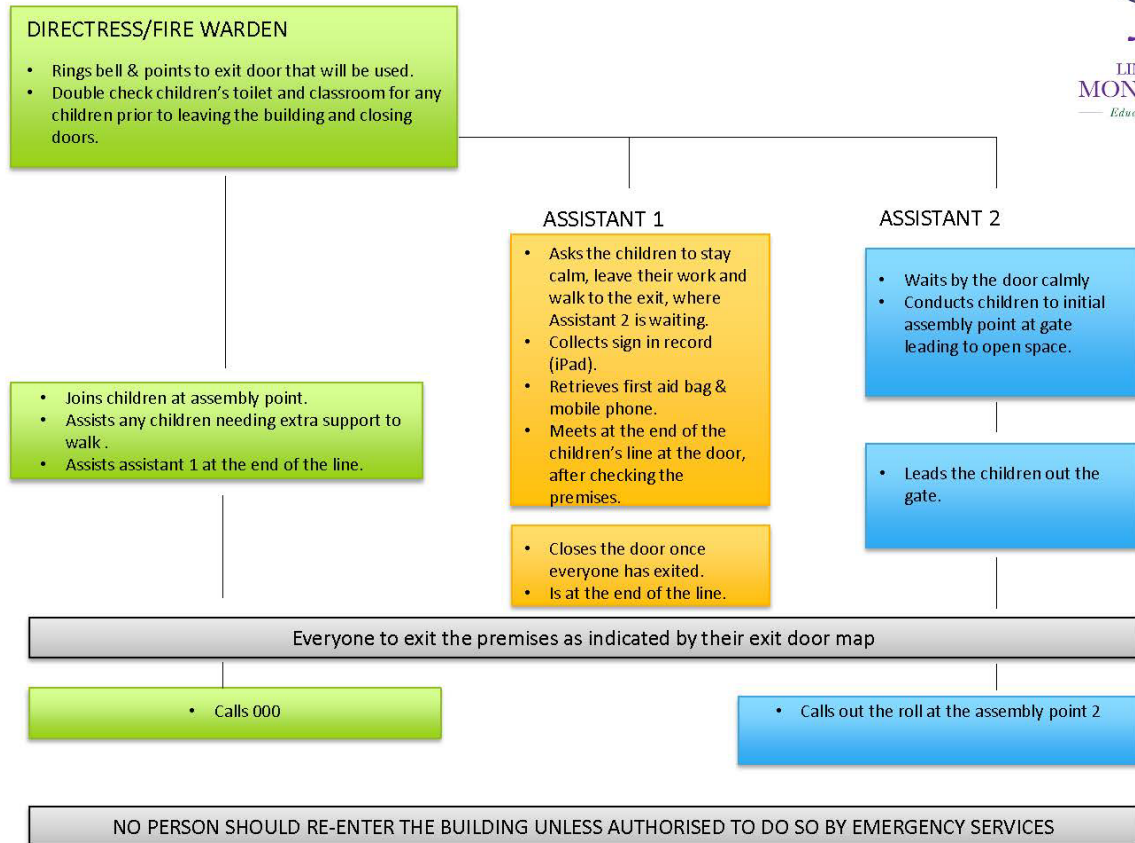

Updated April 2023